

SITE LOCATION PLAN 1:1250

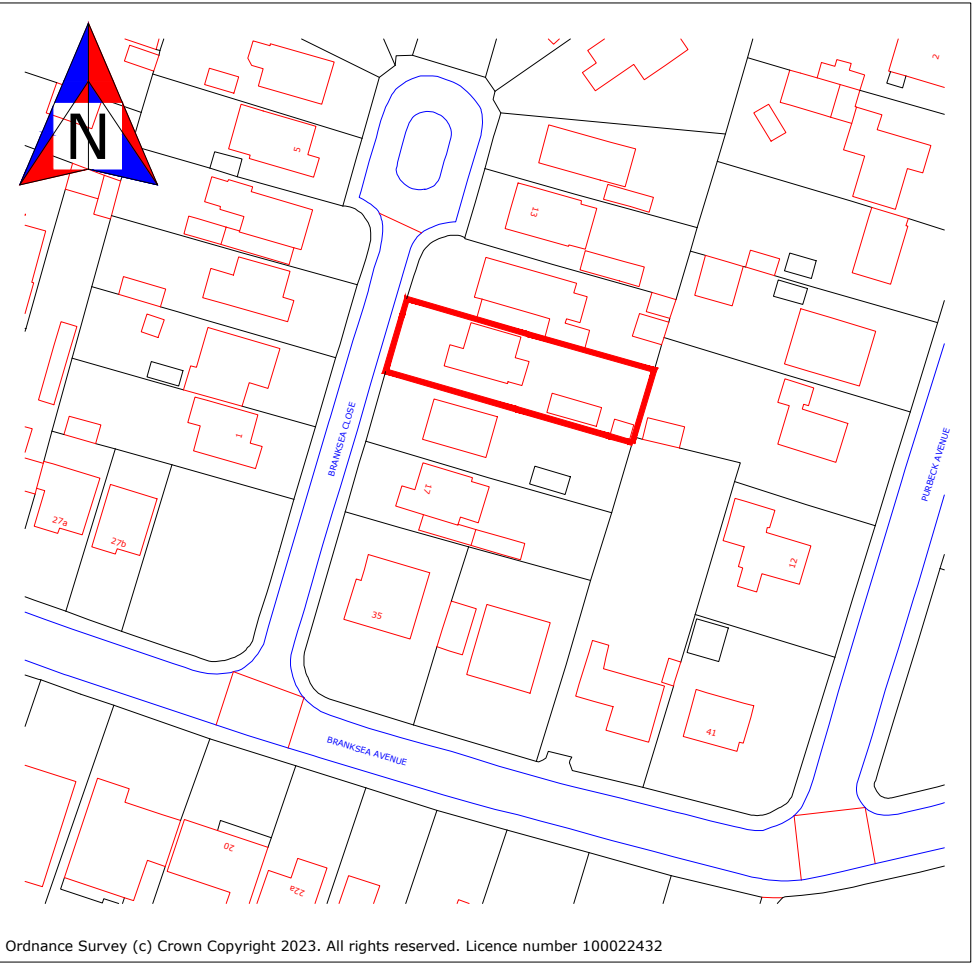

SITE PLAN 1:500

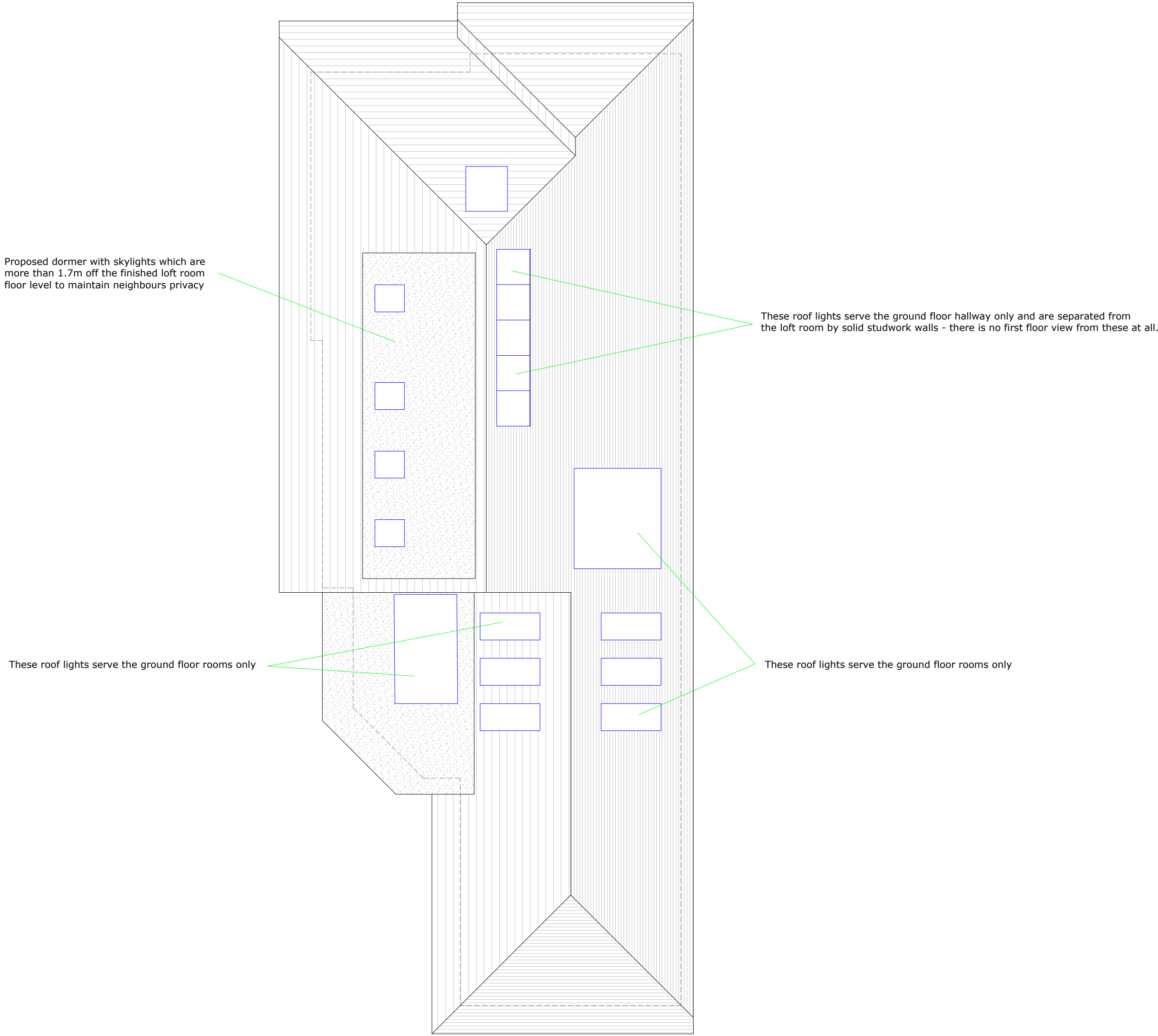
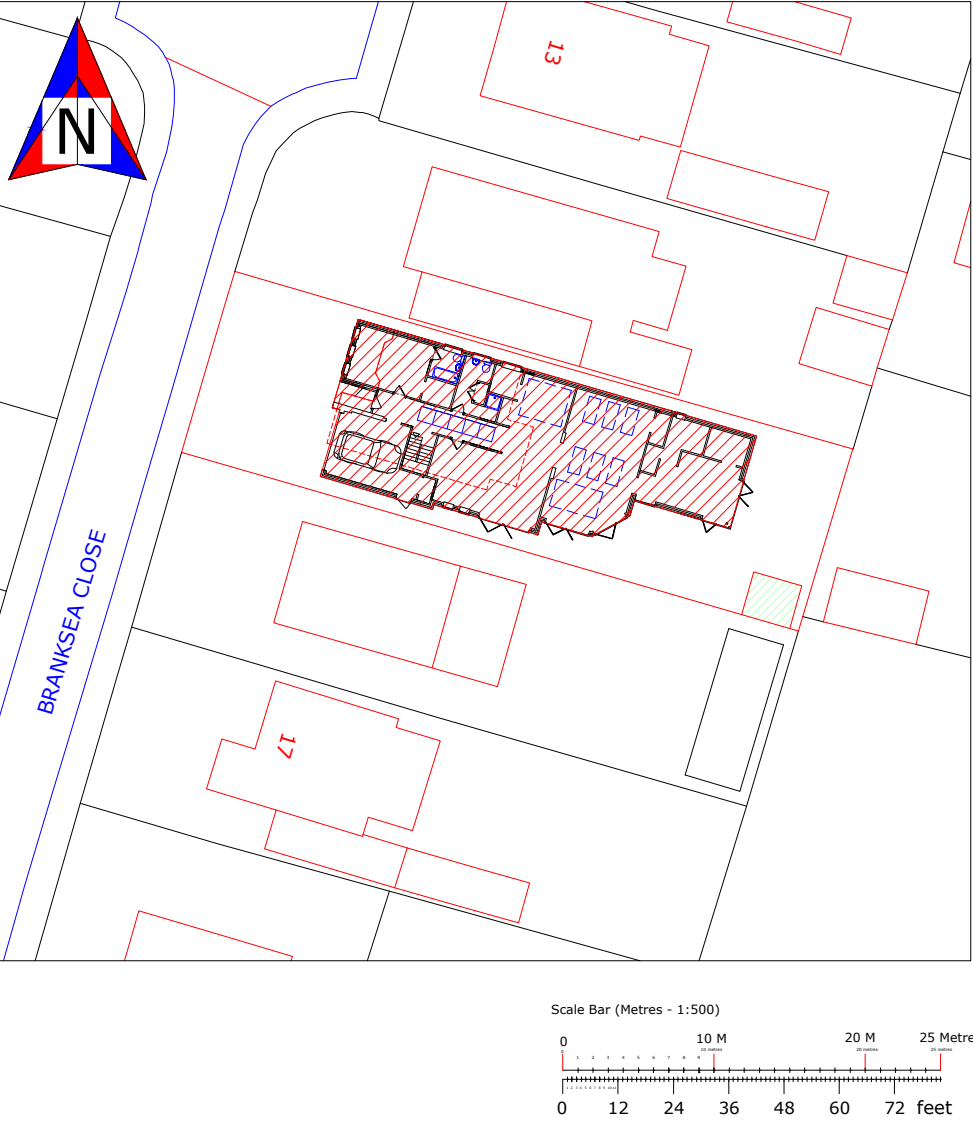

PROPOSALS IN BRIEF

Extend to front, side and rear with new roof and side dormer over.  
Paved car standing to the front.  
Extend dropped kerb to the front.

DRAWING NUMBER  
SHER054

SITE LOCATION

15, BRANKSEA CLOSE  
HAMWORTHY  
DORSET  
BH15 4DR

Submitted for comment to the Local Authority  
Floor plans and elevations 1:100

Measurements in mm and are approximate.

**Extension Design**  
Architects & Planners  
15, BRANKSEA CLOSE  
HAMWORTHY  
DORSET  
BH15 4DR

Richard Stummer  
027 47 51 366  
023 8034 2774  
r.stummer@extensiondesign.co.uk

PAPER SIZE - A1

General notes - please read

Party Wall Act 1996.  
Where building within 3 metres of a neighbour's existing wall is proposed, the Party Wall Act 1996 could apply and is the responsibility of the site owner to implement the Act prior to commencement of works. Further information on this can either be found through the Internet or Extension Design Ltd.

Commencement of works.

- 1) Planning permission, Lawful Development Certificate or Prior Notification applications.
- 2) Where planning permission is required, all conditions of approval must be settled prior to the start of work.
- 3) Where building regulations approval is required, full written approval must be obtained from either the local authority building control or, a private building control company.
- 4) Where structural steelwork is required, a separate certificate from the local authority checking engineers must also be obtained prior to the start of work.
- 5) Where a build over agreement from a local water authority is required - the agreement must be given prior to the start of work.

Work started before these permissions are granted are done so entirely at the site owners own risk.

All measurements shown on these drawings need to be rechecked on site before start of work by the contractor.

If any aspect of these drawings are unclear, please ask. Additional measurements, detail etc can be added if needed. Don't guess - always ask!

These drawings and the electronic master file remain the property of Extension Design Ltd, no further copies can be made without the written permission of Extension Design Ltd.

Extension Design Ltd registered in the United Kingdom No: 0285522. Director: R. A. Stummer (Managing) & R. Stummer (Secretary)